

SITE 03C FSR			
0_Lot No	Gross floor area	Actual Lot Area	FSR

3-09	189.8 m ²	489.6 m ²	38.76%
3-071	184.7 m ²	441.0 m ²	41.88%
3-072	173.6 m ²	352.8 m ²	49.20%
3-081	173.6 m ²	352.8 m ²	49.20%
3-082	174.2 m ²	353.1 m ²	49.33%
Total	895.8 m ²	1989.3 m ²	45.67 %

Site 03A MODEL TYPES	
Lot No.	House Type
3-09	221L-DF40-F1
3-071	220AN-NG4D-F1
3-072	220AK-DF40-F6
3-081	220AK-DF40-F2
3-082	220AA-DF40-F3

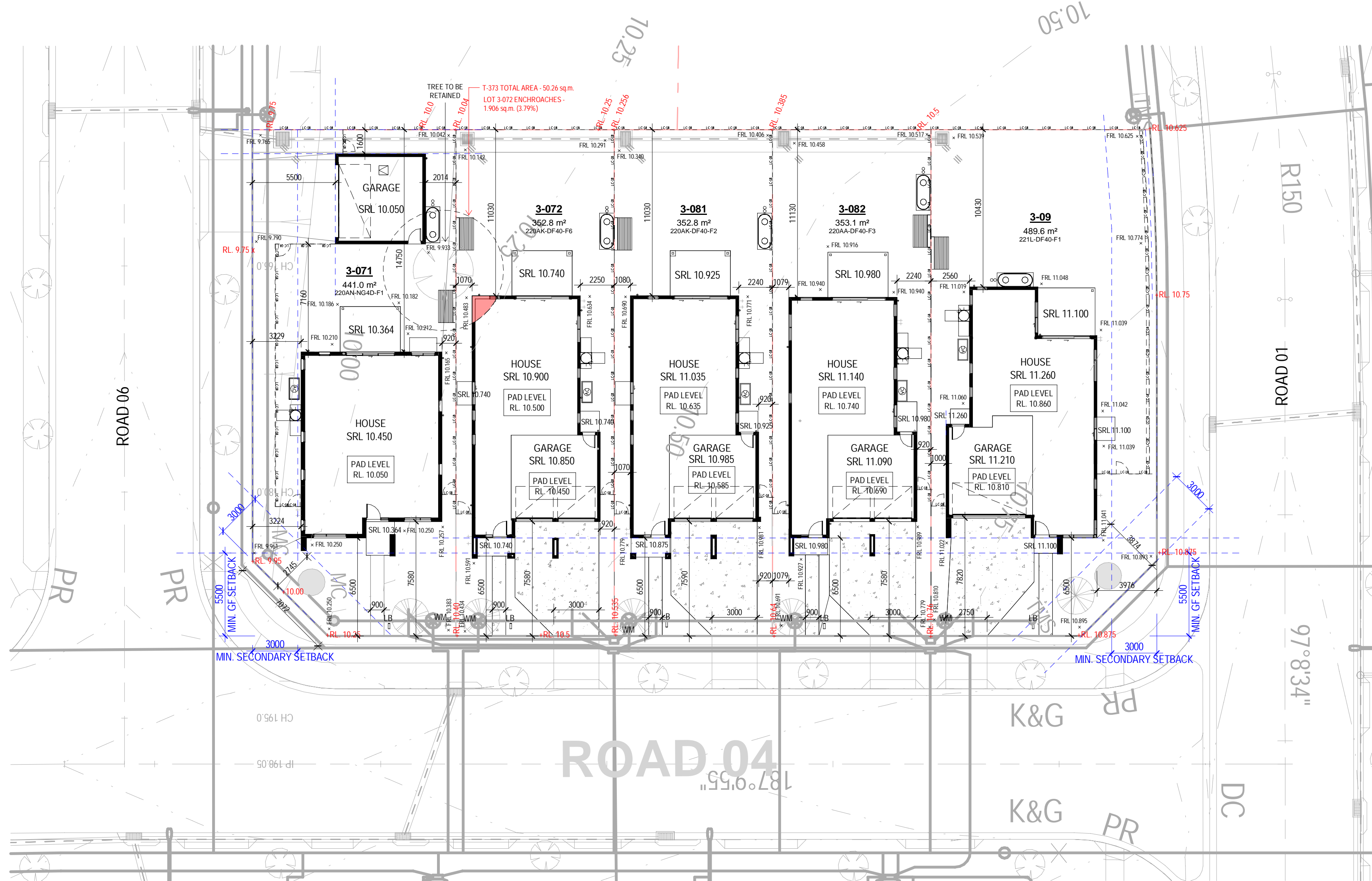

NOTE : VEHICLE CROSSING SHOWN ARE INDICATIVE ONLY. PLEASE REFER TO CIVIL ENGINEERING DRAWINGS FOR DETAILED LOCATION AND DIMENSIONS

1 DA_SITE PLAN
Scale 1:200

[illegible]

NOTE:

- EASEMENT TO DRAIN WATER 1.5m WIDE
- EASEMENT TO DRAIN WATER EASEMENT FOR SERVICES AND RIGHT OF ACCESS
- (X) EASEMENT FOR MAINTENANCE & OVERHANG 1.0m WIDE
- DOWNPIPES CONNECTED TO COUNCIL STORMWATER SYSTEM

IN RESPECT TO PROPOSED RETAINING WALLS CONFINE THE EXTENT OF CUT OR FILL 500mm BEYOND THE WALL ON HIGH SIDE AND BATTER AT A GRADE OF 10% TO PALL LEVEL.

NATURE STRIP CONCEPT DIAGRAM:

The diagram illustrates a cross-section of a nature strip. On the left is the 'ROAD'. To its right is a 'SIDEWALK'. The 'NATURE STRIP' is shown with a '4%' slope, a '0%' level section, and a '20% MAX' slope section. A 'RETAINING WALL' is shown on the right, with a '10%' batter. The diagram is labeled 'NATURE STRIP CONCEPT DIAGRAM' and 'RETAINING STRIP (USE ON DIFFERING SLOPE)'.